

## CALL TO ARTISTS

### LOUISIANA STATE UNIVERSITY (LSU) STUDENT UNION

**OPPORTUNITY:** Large Scale Sculpture or Sculptural Installation with integration into the Plaza  
**LOCATION:** Louisiana State University (LSU) - Baton Rouge, Louisiana  
**COMMISSION BUDGET:** \$543,579  
**APPLICATION DEADLINE:** Friday, August 7, 2015  
All applications **MUST BE** electronically submitted through the CAFÉ system by 10:59 P.M. (CT)



The LSU Student Union, located in the heart of the campus in Baton Rouge, opened in 1964. The facility is 255,000 square feet including meeting rooms, lounges, a food court, a

number of retail outlets and a 1250-seat theater. Construction on a major renovation and expansion of the facility began in 2006.

## STATE OF LOUISIANA PERCENT FOR ART PROGRAM

DEPARTMENT OF CULTURE, RECREATION, AND TOURISM  
OFFICE OF CULTURAL DEVELOPMENT  
DIVISION OF THE ARTS

The Union was built on a block of land that is home to the *LSU Memorial Oak Grove*, beautiful trees that are memorialized for World War I American soldiers. When this site was chosen for the Union, there was one design mandate: do not harm a single oak tree.

Often called the “living room” of the campus, the Union has several key features. It is built on a grid of tall columns, both inside and outside, that “open up” at the top like the branches of trees. On a typical class day, thousands of students walk through the building. The architects’ planning document for the renovation says, “The Union....serves as an *active hub of campus life*.” The facility provides many options for meeting and socializing.



the Parade Grounds on the North-South axis and further elevate the prominence of these two iconic spaces.

### **PROJECT DESCRIPTION**

The Percent for Art Program is seeking artists or artist teams **to design and implement a site-specific, large-scale work of art or sculptural installation of original design that integrates with and enhances the Union’s exterior elements (at the entrance facing the Parade Grounds) of the Louisiana State University (LSU) Student Union in Baton Rouge, LA.**

The artwork will be subject to direct sunlight (UV radiation) and must be unique, permanent, and require very minimal long-term maintenance.

The design goals for the space include enhancing the pedestrian flow, eliminating cars from the front of the facility and creating a new plaza on axis with the front steps that would connect the Union with the LSU Parade Grounds.

Artwork will serve as the focal point for the space and serve as the lynchpin between these two iconic spaces. The artwork within this new space is intended to be contemporary, yet classical in nature and relate to the classical proportions of the LSU Union and grand scale of the Parade Grounds.

The art work in this location should be timeless, unique and embody the spirit of the LSU Community.

Design elements may include (but are not limited to) free-standing sculpture, integrated seating, interactive objects, integrated or accessory lighting, decorative pavers,



Currently the green space in front of the Union is cut off from the Parade Grounds by a one way street and parking. A large portion of the site is dominated by vehicles and restricts pedestrian movement through the space.

The area will be transformed into a grand pedestrian plaza. A small one way access lane will be retained for circulation but the space allocated for parking will be given back to the pedestrians. The paving in the plaza in combination with bollards and other passive traffic calming elements will work in concert to tame the small amount of vehicular traffic flow through the space. This sculpture plaza project will create an uninterrupted pedestrian connection between the Union and



## STATE OF LOUISIANA PERCENT FOR ART PROGRAM

DEPARTMENT OF CULTURE, RECREATION, AND TOURISM  
OFFICE OF CULTURAL DEVELOPMENT  
DIVISION OF THE ARTS

aggregate, stained concrete or other ground design elements that will further accentuate the sculpture or sculptural elements. Any ground treatments must allow for drainage and cannot impede on the root system of the Memorial Oak Grove.

(More detailed specifications will be given to artists selected to develop a proposal.)

### 1. **BUDGET**

The budget listed is inclusive of all costs associated with the project, and commensurate with the intended scale, including but not limited to: research, professional consultations, formal reports from licensed structural and electrical engineers where appropriate, a long-term care and maintenance report from a licensed professional conservator, materials, fabrication, transportation, travel, insurance, installation, photography and documentation of the artwork and crediting plaque.

### 2. **ELIGIBILITY**

This commission is open to professional artists 18 and over, regardless of race, color, national origin, gender, military status, sexual orientation, marital status, or physical or mental disability. Artist teams may apply, and must designate one artist as the lead contact. All artists must have a

minimum of ten (10) years of demonstrated professional visual art experience (not student work) and must have examples of previous experience with large-scale outdoor sculpture or sculptural installation projects. Examples of work submitted must be of original, recently completed artwork. The application, including all examples of work and



supporting documents are considered the artist's official "submission". If any information submitted by the artist or artist's representative, including all supporting documents, is found fraudulent the submission will be disqualified.

### 3. **DESIGN PARAMETERS**

*The development and design for the artwork should:*

- Consider the elements of the site as a source of design ideas
- Consider the facility and its intended uses
- Consider the area surrounding the artwork and its intended uses as described in this call
- Reflect LSU's history, diversity and cultural profile
- Complement the building and the campus' architecture and aesthetic values
- Be durable, sturdy and stable, suitable for the climatic conditions, resistant to UV damage, and safe for public interaction.
- Consider the impact of lighting or lighting as a prominent element. Electrical service will be accommodated where appropriate.



## STATE OF LOUISIANA PERCENT FOR ART PROGRAM

DEPARTMENT OF CULTURE, RECREATION, AND TOURISM  
OFFICE OF CULTURAL DEVELOPMENT  
DIVISION OF THE ARTS

#### 4. HOW TO APPLY

*Artists interested in this project must prepare and submit the following (called the "submission"):*

- A. Résumé
- B. Artist statement
- C. Letter of interest
- D. List of three (3) professional references
- E. Six (6) Images of original completed artwork

#### 5. PREPARING YOUR SUBMISSIONS

- Résumé: Chronological résumé demonstrating a minimum of ten (10) years of professional art experience (exhibitions, sales, commissions etc.). If submitting as a team, a current résumé should be submitted for each team member. A biography will not be accepted in place of a résumé. (Total resume may be up to 5 pages. If your resume exceeds 5 pages, or does not contain your education history and experience with dates, your submission will not be considered) **UPLOAD File should be no larger than 2mb, and txt, pdf, doc, docx, xls, xlsx, or jpg format only.**
- Artist's Statement: Should be a written description of your work to give the committee understanding of or insight into your work. It should inform, connect with an art context, and present the basis for your work. It can be descriptive, or reflective in nature. **(2000 characters max)**
- Letter of Interest: Brief statement summarizing your methods of working, interest in this project, and availability to participate in the design and implementation of the project. **(2000 characters max)**
- References: A list of at least three professional references that have an intimate knowledge of your work and working methods. Include complete addresses and telephone numbers. References will be contacted for artists invited to develop a proposal for the commission. (1-page maximum) **UPLOAD File should be no larger than 2mb, and txt, pdf, doc, docx, xls, xlsx, or jpg format only.**
- Images: Submit six (6) DIGITAL images of your **original completed** artwork, not proposals, which demonstrate your qualifications for the project. 3-D models, sketches, or drawings will not be accepted. You must include the value of the work/commission amount on each image. The value must be indicated in US dollars. Teams may submit a total of six (6) images with at least one image from every team member. Each image must contain only one view of the work. Multiple views *per image* or unexecuted conceptual projects will not be considered, and may disqualify your submission. **Instructions for preparing your images are provided in the (CAFÉ) system.**
- Slides, emailed, or hardcopy mailed submissions will NOT be accepted. **All images must be submitted electronically through the Call for Entry (CAFÉ) system available online at [www.callforentry.org](http://www.callforentry.org)**



The CAFÉ system will remain open until **10:59 P.M. CT on Friday, August 7, 2015** but staff will only be available for assistance until 5:00 P.M. CT. Applicants are encouraged to apply early to reduce risk of technical difficulties. **Incomplete or late submissions will not be accepted for any reason.**

#### 6. SELECTION PROCESS AND CRITERIA

An Art Selection Committee (the Committee) includes representatives from the Louisiana Office of Facility Planning & Control, the architectural firm that designed the facility, representatives from Louisiana State University, and the State Arts Council. The Committee will review all eligible artist submissions.

## STATE OF LOUISIANA PERCENT FOR ART PROGRAM

DEPARTMENT OF CULTURE, RECREATION, AND TOURISM  
OFFICE OF CULTURAL DEVELOPMENT  
DIVISION OF THE ARTS

### Submissions will be evaluated by the following criteria:

- Artistic excellence and originality as evidenced by representations of past work images and other supporting materials
- Appropriateness of artist's medium, style, and previous experience as they relate to the project goals and setting
- Experience with projects of a similar scale and scope
- Availability to participate in the design and implementation of the project as required
- Special consideration will be given to Louisiana Artists, as defined by La. R.S. 25:9000.1(E)
- The committee may also take into consideration when selecting artists whether or not an artist is already represented in the state's collection.

### 7. TIMELINE & PROJECT SCHEDULE

**Submission deadline:** Submissions must be received through the CAFÉ online system by **Friday, August 7, 2015 at 10:59 P.M. CT. We cannot accept late, hand-delivered, mailed or emailed submissions.**

#### Estimated Project Schedule

Applications due .....	<b>Friday, August 7, 2015</b>
Committee meeting .....	September 2015
Notifications .....	October 2015
Proposal development process (60 days) .....	Nov. - Dec. 2015
Proposal presentations .....	January 2016
Notification of selection .....	February 2016
Contracting .....	March 2016 - March 2017
Installation must be completed .....	March 2017

**The Percent for Art Program reserves the right to modify the project timeline (other than the deadline to receive applications).**

### 8. NOTIFICATIONS AND PROPOSALS: The anticipated date for notifications is **October 2015**.

***This is a call for submission of samples of previous work and qualifications only. If selected to develop a proposal for one of the commissions, you will be contacted by Percent for Art program staff with further details about the site, concept and scope.***

**Finalists will be required to attend two meetings, in person, in Louisiana.**

The first will be a site visit to meet with the Committee and to see the space. The second will be approximately 60 days later to present the artist's proposal to the Committee.

The proposal must include the concept, materials, size, weight, installation requirements, details of maintenance, and budget. ***The proposal must also include a maquette and digital renderings of the work in-situ, which shows the physical volume of the space and allows for multiple perspectives of the artwork within the space.***

All proposal documents, including the maquette and renderings, will become property of the State of Louisiana and will be used for educational and/or promotional purposes of the program. Each finalist's proposal and/or maquette may be exhibited for Committee and community consideration.

**A proposal fee of \$2,000 will be paid to finalists to offset expenses associated with development of proposals and travel to present to the Committee.**





**STATE OF LOUISIANA  
PERCENT FOR ART PROGRAM**

DEPARTMENT OF CULTURE, RECREATION, AND TOURISM  
OFFICE OF CULTURAL DEVELOPMENT  
DIVISION OF THE ARTS

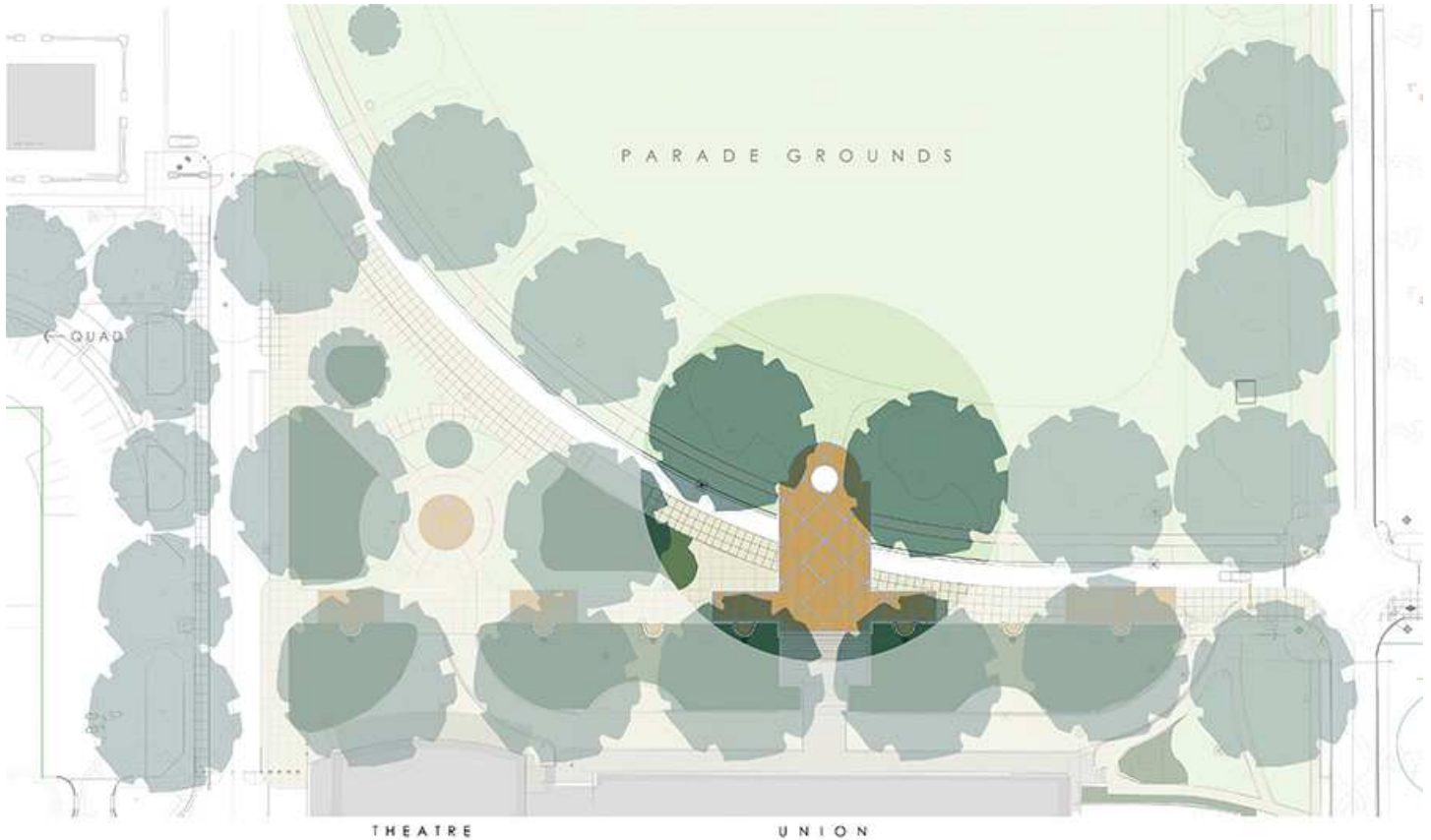

*Site Plan: (See Above)*

*NOTE: The Percent for Art Program and the Artist Selection Committee reserve the right to reject any or all applications or proposals, to reject any finalist, or to terminate the selection process for any project without prior notice.*

---

*The Louisiana Percent for Art Program was established by law in the 1999 legislative session. The law specifies that on projects using more than \$2,000,000 in state funds, one percent (1%) of the expenditure for construction or renovation of a state building shall be for works of art by artists and craftsmen for the building or its grounds.*

*This program is administered by the Office of Cultural Development /Division of the Arts, in the Department of Culture Recreation and Tourism of the State of Louisiana, in collaboration with the Division of Administration and the Office of Facility Planning and Control.*

---

Please direct questions about the Percent for Art Program or this project to: **Dána LaFonta**, Director of Artist Services and the Percent for Art Program. Phone: 225-342-8176 or Email: [dlafonta@crt.la.gov](mailto:dlafonta@crt.la.gov)

Website: <http://www.crt.state.la.us/cultural-development/arts/>